

# Residential Site Plan

## Level 3

### UNIT MIX

JR 1 BEDROOM	12 RESIDENCES		
Residence B	Line 03–07, 18, 30–32, 34	375 SF	35 SM
Residence B5	Line 33	375 SF	35 SM
Residence B6	Line 35	375 SF	35 SM
1 BEDROOM	5 RESIDENCES		
Residence A	Line 01, 02	628 SF	58 SM
Residence D	Line 36	550 SF	51 SM
Residence C.A	Line 16	644 SF	60 SM
Residence G	Line 20	603 SF	56 SM

(.A) INDICATES ADA TYPE RESIDENCE



STATED DIMENSIONS ARE MEASURED TO THE EXTERIOR BOUNDARIES OF THE EXTERIOR WALLS AND THE CENTERLINE OF INTERIOR DEMISING WALLS AND IN FACT VARY FROM THE DIMENSIONS THAT WOULD BE DETERMINED BY USING THE DESCRIPTION AND DEFINITION OF THE "UNIT" SET FORTH IN THE DECLARATION (WHICH GENERALLY ONLY INCLUDES THE INTERIOR AIRSPACE BETWEEN THE PERIMETER WALLS AND EXCLUDES INTERIOR STRUCTURAL COMPONENTS). FOR YOUR REFERENCE, THE AREA OF THE UNIT, DETERMINED IN ACCORDANCE WITH THOSE DEFINED UNIT BOUNDARIES, NOTE THAT MEASUREMENTS OF ROOMS SET FORTH ON THIS FLOOR PLAN ARE GENERALLY TAKEN AT THE GREATEST POINTS OF EACH GIVEN ROOM (AS IF THE ROOM WERE A PERFECT RECTANGLE), WITHOUT REGARD FOR ANY CUTOUTS. ACCORDINGLY, THE AREA OF THE ACTUAL ROOM WILL TYPICALLY BE SMALLER THAN THE PRODUCT OBTAINED BY MULTIPLYING THE STATED LENGTH TIMES WIDTH. ALL DIMENSIONS ARE APPROXIMATE AND MAY VARY WITH ACTUAL CONSTRUCTION, AND ALL FLOOR PLANS AND DEVELOPMENT PLANS ARE SUBJECT TO CHANGE.

# Residential Site Plan

## Level 4

### UNIT MIX

JR 1 BEDROOM	26 RESIDENCES		
Residence B	Line 03–08, 13, 15, 17, 18, 21–26, 28, 30–32, 34	375 SF	35 SM
Residence B3	Line 27	375 SF	35 SM
Residence B4	Line 36	375 SF	35 SM
Residence B5	Line 33	375 SF	35 SM
Residence B6	Line 35	375 SF	35 SM
Residence H	Line 29	408 SF	38 SM
1 BEDROOM	4 RESIDENCES		
Residence A	Line 01, 02	628 SF	58 SM
Residence C.A	Line 16	644 SF	60 SM
Residence E	Line 37	572 SF	53 SM
1 BED + DEN	2 RESIDENCES		
Residence F	Line 19	613 SF	57 SM
Residence G	Line 20	603 SF	56 SM

(.A) INDICATES ADA TYPE RESIDENCE

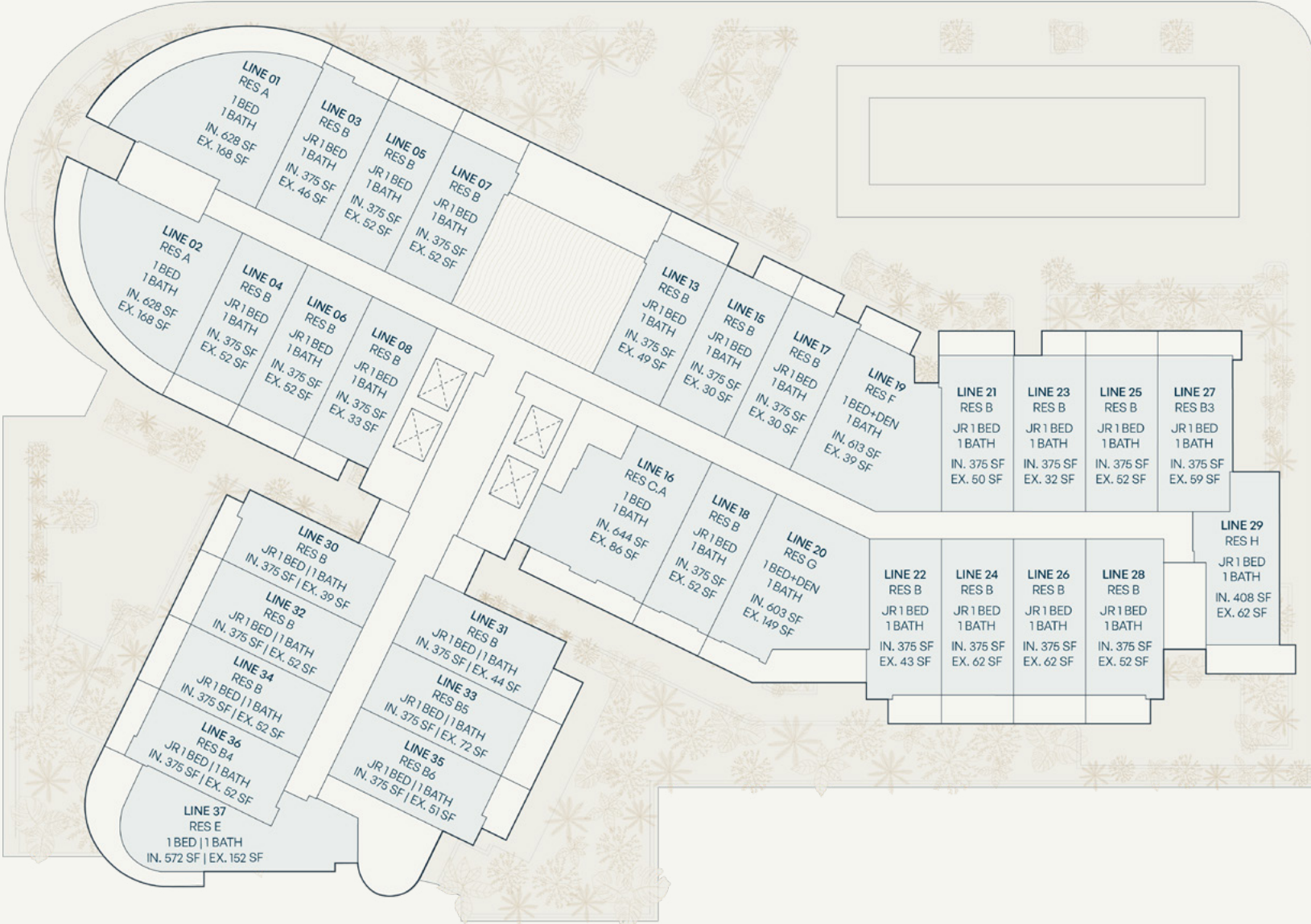

STATED DIMENSIONS ARE MEASURED TO THE EXTERIOR BOUNDARIES OF THE EXTERIOR WALLS AND THE CENTERLINE OF INTERIOR DEMISING WALLS AND IN FACT VARY FROM THE DIMENSIONS THAT WOULD BE DETERMINED BY USING THE DESCRIPTION AND DEFINITION OF THE "UNIT" SET FORTH IN THE DECLARATION (WHICH GENERALLY ONLY INCLUDES THE INTERIOR AIRSPACE BETWEEN THE PERIMETER WALLS AND EXCLUDES INTERIOR STRUCTURAL COMPONENTS). FOR YOUR REFERENCE, THE AREA OF THE UNIT, DETERMINED IN ACCORDANCE WITH THOSE DEFINED UNIT BOUNDARIES, NOTE THAT MEASUREMENTS OF ROOMS SET FORTH ON THIS FLOOR PLAN ARE GENERALLY TAKEN AT THE GREATEST POINTS OF EACH GIVEN ROOM (AS IF THE ROOM WERE A PERFECT RECTANGLE), WITHOUT REGARD FOR ANY CUTOUTS. ACCORDINGLY, THE AREA OF THE ACTUAL ROOM WILL TYPICALLY BE SMALLER THAN THE PRODUCT OBTAINED BY MULTIPLYING THE STATED LENGTH TIMES WIDTH. ALL DIMENSIONS ARE APPROXIMATE AND MAY VARY WITH ACTUAL CONSTRUCTION, AND ALL FLOOR PLANS AND DEVELOPMENT PLANS ARE SUBJECT TO CHANGE.



# Residential Site Plan

## Level 5

### UNIT MIX

JR 1 BEDROOM	24 RESIDENCES		
Residence B	Line 03, 04, 06, 08, 17, 18, 21–26, 28, 30–32, 34	375 SF	35 SM
Residence B1	Line 09, 11	420 SF	39 SM
Residence B3	Line 27	375 SF	35 SM
Residence B4	Line 36	375 SF	35 SM
Residence B5	Line 33	375 SF	35 SM
Residence B6	Line 35	375 SF	35 SM
Residence H	Line 29	408 SF	38 SM
1 BEDROOM	3 RESIDENCES		
Residence A	Line 01, 02	628 SF	58 SM
Residence E	Line 37	572 SF	53 SM
1 BED + DEN	5 RESIDENCES		
Residence C	Line 16	644 SF	58 SM
Residence F	Line 19	613 SF	57 SM
Residence G	Line 20	603 SF	56 SM
Residence J	Line 07, 15	751 SF	70 SM

(.A) INDICATES ADA TYPE RESIDENCE

NORTHLINK CAPITAL



STATED DIMENSIONS ARE MEASURED TO THE EXTERIOR BOUNDARIES OF THE EXTERIOR WALLS AND THE CENTERLINE OF INTERIOR DEMISING WALLS AND IN FACT VARY FROM THE DIMENSIONS THAT WOULD BE DETERMINED BY USING THE DESCRIPTION AND DEFINITION OF THE "UNIT" SET FORTH IN THE DECLARATION (WHICH GENERALLY ONLY INCLUDES THE INTERIOR AIRSPACE BETWEEN THE PERIMETER WALLS AND EXCLUDES INTERIOR STRUCTURAL COMPONENTS). FOR YOUR REFERENCE, THE AREA OF THE UNIT, DETERMINED IN ACCORDANCE WITH THOSE DEFINED UNIT BOUNDARIES, NOTE THAT MEASUREMENTS OF ROOMS SET FORTH ON THIS FLOOR PLAN ARE GENERALLY TAKEN AT THE GREATEST POINTS OF EACH GIVEN ROOM (AS IF THE ROOM WERE A PERFECT RECTANGLE), WITHOUT REGARD FOR ANY CUTOUTS. ACCORDINGLY, THE AREA OF THE ACTUAL ROOM WILL TYPICALLY BE SMALLER THAN THE PRODUCT OBTAINED BY MULTIPLYING THE STATED LENGTH TIMES WIDTH. ALL DIMENSIONS ARE APPROXIMATE AND MAY VARY WITH ACTUAL CONSTRUCTION, AND ALL FLOOR PLANS AND DEVELOPMENT PLANS ARE SUBJECT TO CHANGE.



# Residential Site Plan

## Level 6

### UNIT MIX

JR 1 BEDROOM	24 RESIDENCES		
Residence B	Line 03, 04, 06, 08, 17, 18, 21–26, 28, 30–32, 34	375 SF	35 SM
Residence B1	Line 09, 11	420 SF	39 SM
Residence B3	Line 27	375 SF	35 SM
Residence B4	Line 36	375 SF	35 SM
Residence B5	Line 33	375 SF	35 SM
Residence B6	Line 35	375 SF	35 SM
Residence H	Line 29	408 SF	38 SM
1 BEDROOM	4 RESIDENCES		
Residence A	Line 01, 02	628 SF	58 SM
Residence E	Line 37	572 SF	53 SM
Residence F.A	Line 19	613 SF	57 SM
1 BED + DEN	4 RESIDENCES		
Residence C	Line 16	644 SF	58 SM
Residence G	Line 20	603 SF	56 SM
Residence J	Line 07, 15	751 SF	70 SM

(.A) INDICATES ADA TYPE RESIDENCE

NORTHLINK CAPITAL



STATED DIMENSIONS ARE MEASURED TO THE EXTERIOR BOUNDARIES OF THE EXTERIOR WALLS AND THE CENTERLINE OF INTERIOR DEMISING WALLS AND IN FACT VARY FROM THE DIMENSIONS THAT WOULD BE DETERMINED BY USING THE DESCRIPTION AND DEFINITION OF THE "UNIT" SET FORTH IN THE DECLARATION (WHICH GENERALLY ONLY INCLUDES THE INTERIOR AIRSPACE BETWEEN THE PERIMETER WALLS AND EXCLUDES INTERIOR STRUCTURAL COMPONENTS). FOR YOUR REFERENCE, THE AREA OF THE UNIT, DETERMINED IN ACCORDANCE WITH THOSE DEFINED UNIT BOUNDARIES, NOTE THAT MEASUREMENTS OF ROOMS SET FORTH ON THIS FLOOR PLAN ARE GENERALLY TAKEN AT THE GREATEST POINTS OF EACH GIVEN ROOM (AS IF THE ROOM WERE A PERFECT RECTANGLE), WITHOUT REGARD FOR ANY CUTOUTS. ACCORDINGLY, THE AREA OF THE ACTUAL ROOM WILL TYPICALLY BE SMALLER THAN THE PRODUCT OBTAINED BY MULTIPLYING THE STATED LENGTH TIMES WIDTH. ALL DIMENSIONS ARE APPROXIMATE AND MAY VARY WITH ACTUAL CONSTRUCTION, AND ALL FLOOR PLANS AND DEVELOPMENT PLANS ARE SUBJECT TO CHANGE.

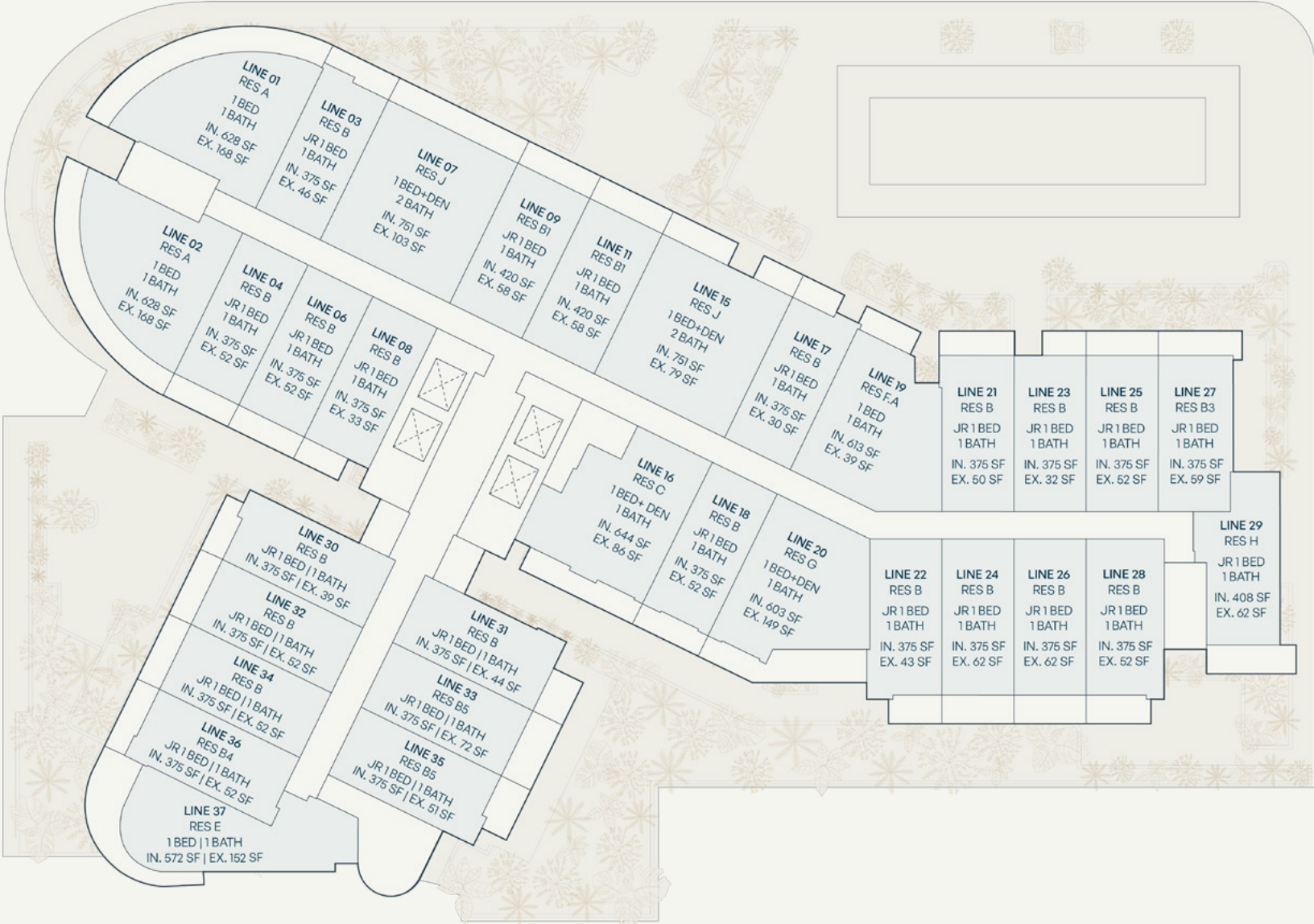



# Residential Site Plan

## Level 7

### UNIT MIX

JR 1 BEDROOM	24 RESIDENCES		
Residence B	Line 03, 04, 06, 08, 17, 18, 21–26, 28, 30–32, 34	375 SF	35 SM
Residence B1	Line 09, 11	420 SF	39 SM
Residence B3	Line 27	375 SF	35 SM
Residence B4	Line 36	375 SF	35 SM
Residence B5	Line 33	375 SF	35 SM
Residence B6	Line 35	375 SF	35 SM
Residence H	Line 29	408 SF	38 SM
1 BEDROOM	3 RESIDENCES		
Residence A	Line 01, 02	628 SF	58 SM
Residence E	Line 37	572 SF	53 SM
1 BED + DEN	5 RESIDENCES		
Residence C	Line 16	644 SF	58 SM
Residence F	Line 19	613 SF	57 SM
Residence G	Line 20	603 SF	56 SM
Residence J	Line 07, 15	751 SF	70 SM

(.A) INDICATES ADA TYPE RESIDENCE



STATED DIMENSIONS ARE MEASURED TO THE EXTERIOR BOUNDARIES OF THE EXTERIOR WALLS AND THE CENTERLINE OF INTERIOR DEMISING WALLS AND IN FACT VARY FROM THE DIMENSIONS THAT WOULD BE DETERMINED BY USING THE DESCRIPTION AND DEFINITION OF THE "UNIT" SET FORTH IN THE DECLARATION (WHICH GENERALLY ONLY INCLUDES THE INTERIOR AIRSPACE BETWEEN THE PERIMETER WALLS AND EXCLUDES INTERIOR STRUCTURAL COMPONENTS). FOR YOUR REFERENCE, THE AREA OF THE UNIT, DETERMINED IN ACCORDANCE WITH THOSE DEFINED UNIT BOUNDARIES, NOTE THAT MEASUREMENTS OF ROOMS SET FORTH ON THIS FLOOR PLAN ARE GENERALLY TAKEN AT THE GREATEST POINTS OF EACH GIVEN ROOM (AS IF THE ROOM WERE A PERFECT RECTANGLE), WITHOUT REGARD FOR ANY CUTOUTS. ACCORDINGLY, THE AREA OF THE ACTUAL ROOM WILL TYPICALLY BE SMALLER THAN THE PRODUCT OBTAINED BY MULTIPLYING THE STATED LENGTH TIMES WIDTH. ALL DIMENSIONS ARE APPROXIMATE AND MAY VARY WITH ACTUAL CONSTRUCTION, AND ALL FLOOR PLANS AND DEVELOPMENT PLANS ARE SUBJECT TO CHANGE.



# Residential Site Plan

## Level 8

### UNIT MIX

JR 1 BEDROOM	15 RESIDENCES		
Residence B	Line 03, 04, 17, 18, 21–26, 28	375 SF	35 SM
Residence B1	Line 09, 11	420 SF	39 SM
Residence B3	Line 27	375 SF	35 SM
Residence H	Line 29	408 SF	38 SM
1 BEDROOM	3 RESIDENCES		
Residence A	Line 01, 02	628 SF	58 SM
Residence C.A	Line 16	644 SF	60 SM
1 BED + DEN	5 RESIDENCES		
Residence F	Line 19	613 SF	57 SM
Residence G	Line 20	603 SF	56 SM
Residence J	Line 07, 15	751 SF	70 SM
Residence J1	Line 06	757 SF	70 SM

(.A) INDICATES ADA TYPE RESIDENCE



STATED DIMENSIONS ARE MEASURED TO THE EXTERIOR BOUNDARIES OF THE EXTERIOR WALLS AND THE CENTERLINE OF INTERIOR DEMISING WALLS AND IN FACT VARY FROM THE DIMENSIONS THAT WOULD BE DETERMINED BY USING THE DESCRIPTION AND DEFINITION OF THE "UNIT" SET FORTH IN THE DECLARATION (WHICH GENERALLY ONLY INCLUDES THE INTERIOR AIRSPACE BETWEEN THE PERIMETER WALLS AND EXCLUDES INTERIOR STRUCTURAL COMPONENTS). FOR YOUR REFERENCE, THE AREA OF THE UNIT, DETERMINED IN ACCORDANCE WITH THOSE DEFINED UNIT BOUNDARIES, NOTE THAT MEASUREMENTS OF ROOMS SET FORTH ON THIS FLOOR PLAN ARE GENERALLY TAKEN AT THE GREATEST POINTS OF EACH GIVEN ROOM (AS IF THE ROOM WERE A PERFECT RECTANGLE), WITHOUT REGARD FOR ANY CUTOUTS. ACCORDINGLY, THE AREA OF THE ACTUAL ROOM WILL TYPICALLY BE SMALLER THAN THE PRODUCT OBTAINED BY MULTIPLYING THE STATED LENGTH TIMES WIDTH. ALL DIMENSIONS ARE APPROXIMATE AND MAY VARY WITH ACTUAL CONSTRUCTION, AND ALL FLOOR PLANS AND DEVELOPMENT PLANS ARE SUBJECT TO CHANGE.



# Residential Site Plan

## Level 9

### UNIT MIX

JR 1 BEDROOM	13 RESIDENCES		
Residence B	Line 03, 04, 17, 18, 21–26, 28	375 SF	35 SM
Residence B3	Line 27	375 SF	35 SM
Residence H	Line 29	408 SF	38 SM
1 BEDROOM	3 RESIDENCES		
Residence A	Line 01, 02	628 SF	58 SM
Residence F.A	Line 19	613 SF	57 SM
1 BED + DEN	6 RESIDENCES		
Residence C	Line 16	644 SF	60 SM
Residence G	Line 20	603 SF	56 SM
Residence J	Line 07, 15	751 SF	70 SM
Residence J1	Line 06	757 SF	70 SM
Residence J2	Line 09	841 SF	78 SM

(.A) INDICATES ADA TYPE RESIDENCE

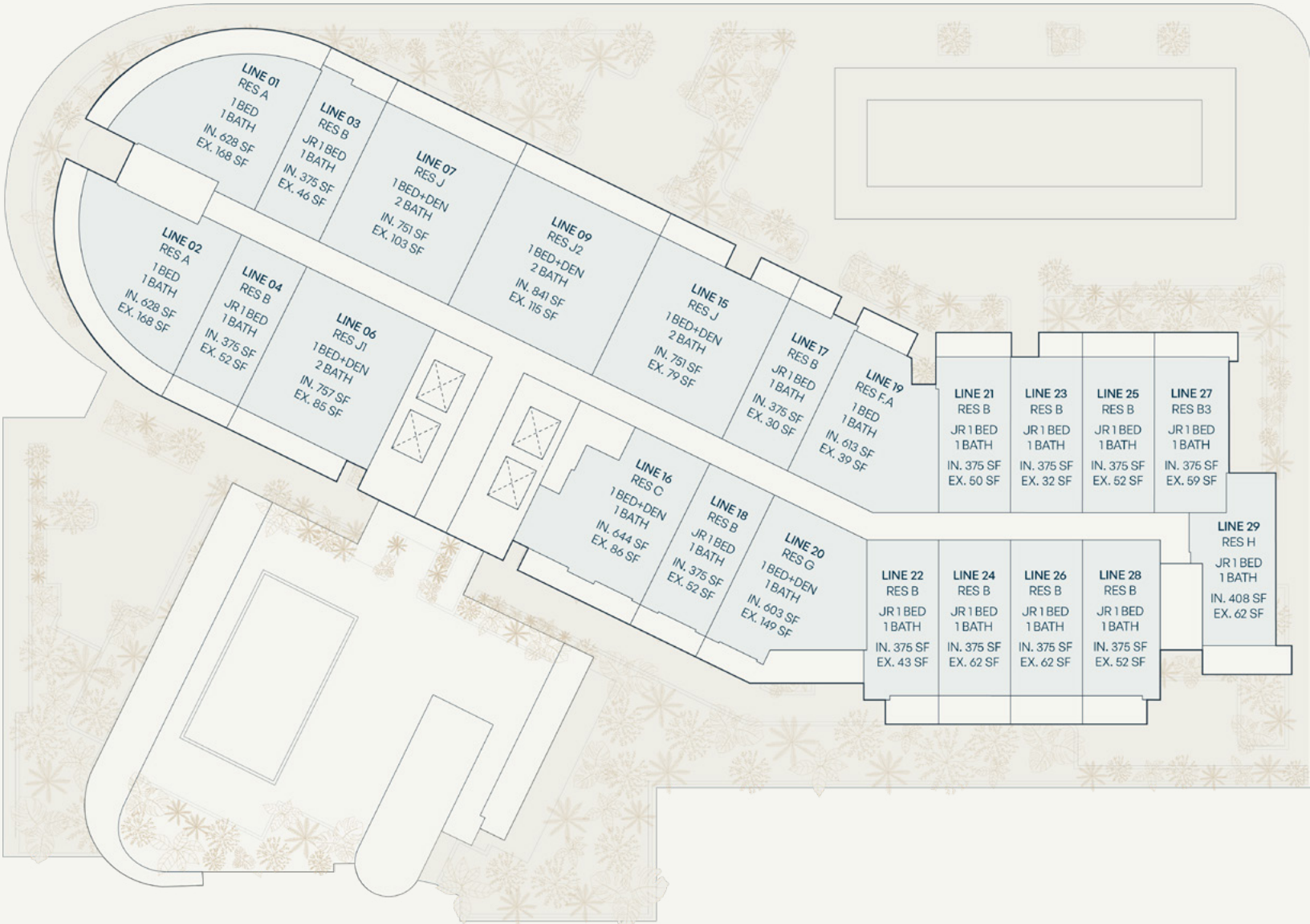

STATED DIMENSIONS ARE MEASURED TO THE EXTERIOR BOUNDARIES OF THE EXTERIOR WALLS AND THE CENTERLINE OF INTERIOR DEMISING WALLS AND IN FACT VARY FROM THE DIMENSIONS THAT WOULD BE DETERMINED BY USING THE DESCRIPTION AND DEFINITION OF THE "UNIT" SET FORTH IN THE DECLARATION (WHICH GENERALLY ONLY INCLUDES THE INTERIOR AIRSPACE BETWEEN THE PERIMETER WALLS AND EXCLUDES INTERIOR STRUCTURAL COMPONENTS). FOR YOUR REFERENCE, THE AREA OF THE UNIT, DETERMINED IN ACCORDANCE WITH THOSE DEFINED UNIT BOUNDARIES, NOTE THAT MEASUREMENTS OF ROOMS SET FORTH ON THIS FLOOR PLAN ARE GENERALLY TAKEN AT THE GREATEST POINTS OF EACH GIVEN ROOM (AS IF THE ROOM WERE A PERFECT RECTANGLE), WITHOUT REGARD FOR ANY CUTOUTS. ACCORDINGLY, THE AREA OF THE ACTUAL ROOM WILL TYPICALLY BE SMALLER THAN THE PRODUCT OBTAINED BY MULTIPLYING THE STATED LENGTH TIMES WIDTH. ALL DIMENSIONS ARE APPROXIMATE AND MAY VARY WITH ACTUAL CONSTRUCTION, AND ALL FLOOR PLANS AND DEVELOPMENT PLANS ARE SUBJECT TO CHANGE.

# Residential Site Plan

## Level 10

### UNIT MIX

1 BED + DEN		5 RESIDENCES	
Residence G	Line 20	603 SF	56 SM
Residence J	Line 21, 22, 26	751 SF	70 SM
Residence J1	Line 06	757 SF	67 SM
2 BEDROOMS		1 RESIDENCE	
Residence M.A	Line 17	989 SF	92 SM
2 BED + DEN		6 RESIDENCES	
Residence C1	Line 16	1,016 SF	94 SM
Residence K	Line 07, 13	1,171 SF	109 SM
Residence L	Line 01, 02	1,011 SF	94 SM
Residence N	Line 27	1,186 SF	110 SM

(.A) INDICATES ADA TYPE RESIDENCE

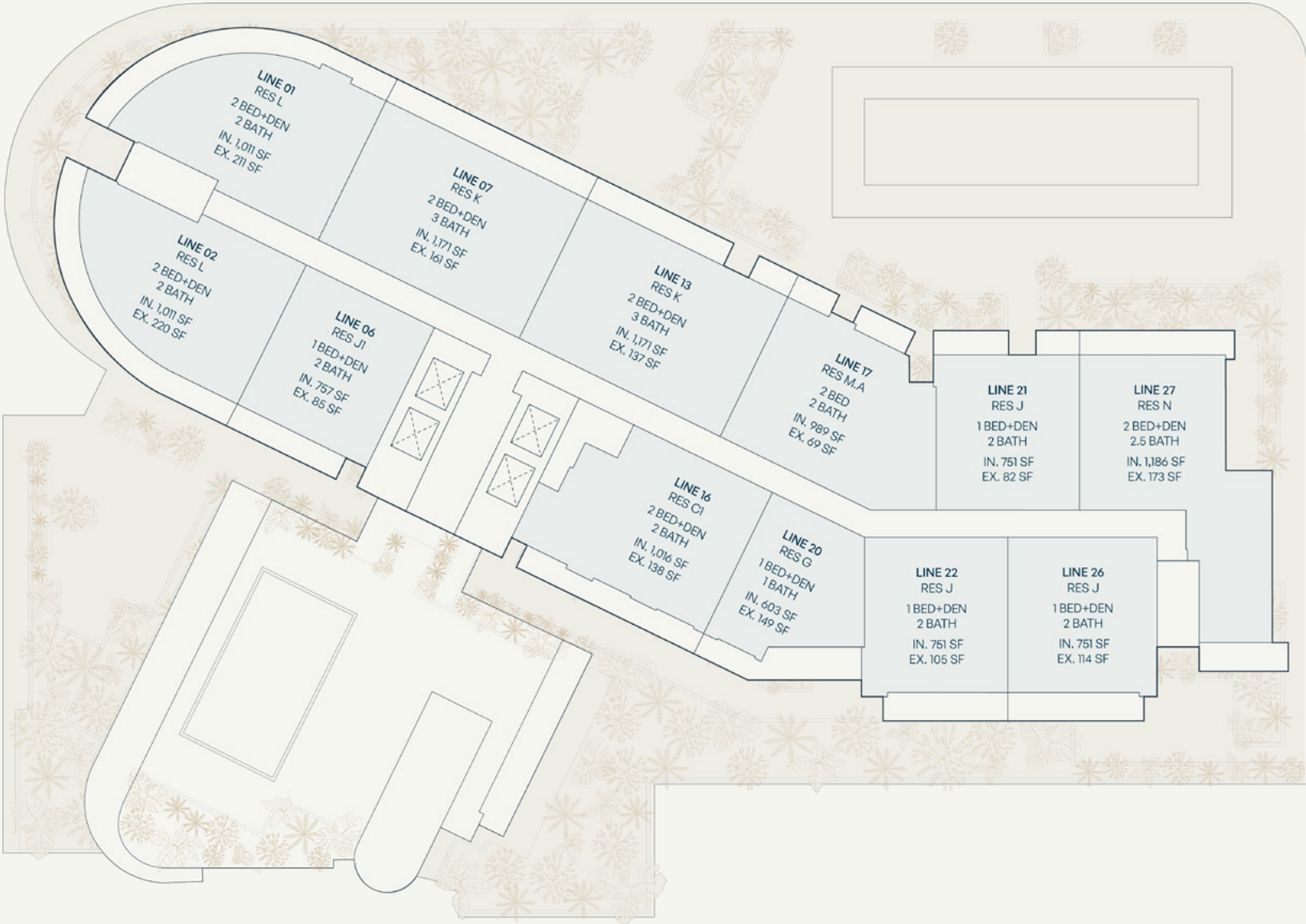

STATED DIMENSIONS ARE MEASURED TO THE EXTERIOR BOUNDARIES OF THE EXTERIOR WALLS AND THE CENTERLINE OF INTERIOR DEMISING WALLS AND IN FACT VARY FROM THE DIMENSIONS THAT WOULD BE DETERMINED BY USING THE DESCRIPTION AND DEFINITION OF THE "UNIT" SET FORTH IN THE DECLARATION (WHICH GENERALLY ONLY INCLUDES THE INTERIOR AIRSPACE BETWEEN THE PERIMETER WALLS AND EXCLUDES INTERIOR STRUCTURAL COMPONENTS). FOR YOUR REFERENCE, THE AREA OF THE UNIT, DETERMINED IN ACCORDANCE WITH THOSE DEFINED UNIT BOUNDARIES, NOTE THAT MEASUREMENTS OF ROOMS SET FORTH ON THIS FLOOR PLAN ARE GENERALLY TAKEN AT THE GREATEST POINTS OF EACH GIVEN ROOM (AS IF THE ROOM WERE A PERFECT RECTANGLE), WITHOUT REGARD FOR ANY CUTOUTS. ACCORDINGLY, THE AREA OF THE ACTUAL ROOM WILL TYPICALLY BE SMALLER THAN THE PRODUCT OBTAINED BY MULTIPLYING THE STATED LENGTH TIMES WIDTH. ALL DIMENSIONS ARE APPROXIMATE AND MAY VARY WITH ACTUAL CONSTRUCTION, AND ALL FLOOR PLANS AND DEVELOPMENT PLANS ARE SUBJECT TO CHANGE.



# Residential Site Plan

## Level 11

### UNIT MIX

1 BED + DEN		5 RESIDENCES	
Residence G	Line 20	603 SF	56 SM
Residence J	Line 21, 22, 26	751 SF	70 SM
Residence J1	Line 06	757 SF	67 SM
2 BED + DEN		7 RESIDENCES	
Residence C1.A	Line 16	1,016 SF	94 SM
Residence K	Line 07, 13	1,171 SF	109 SM
Residence L	Line 01, 02	1,011 SF	94 SM
Residence M	Line 17	989 SF	92 SM
Residence N	Line 27	1,186 SF	110 SM

(.A) INDICATES ADA TYPE RESIDENCE

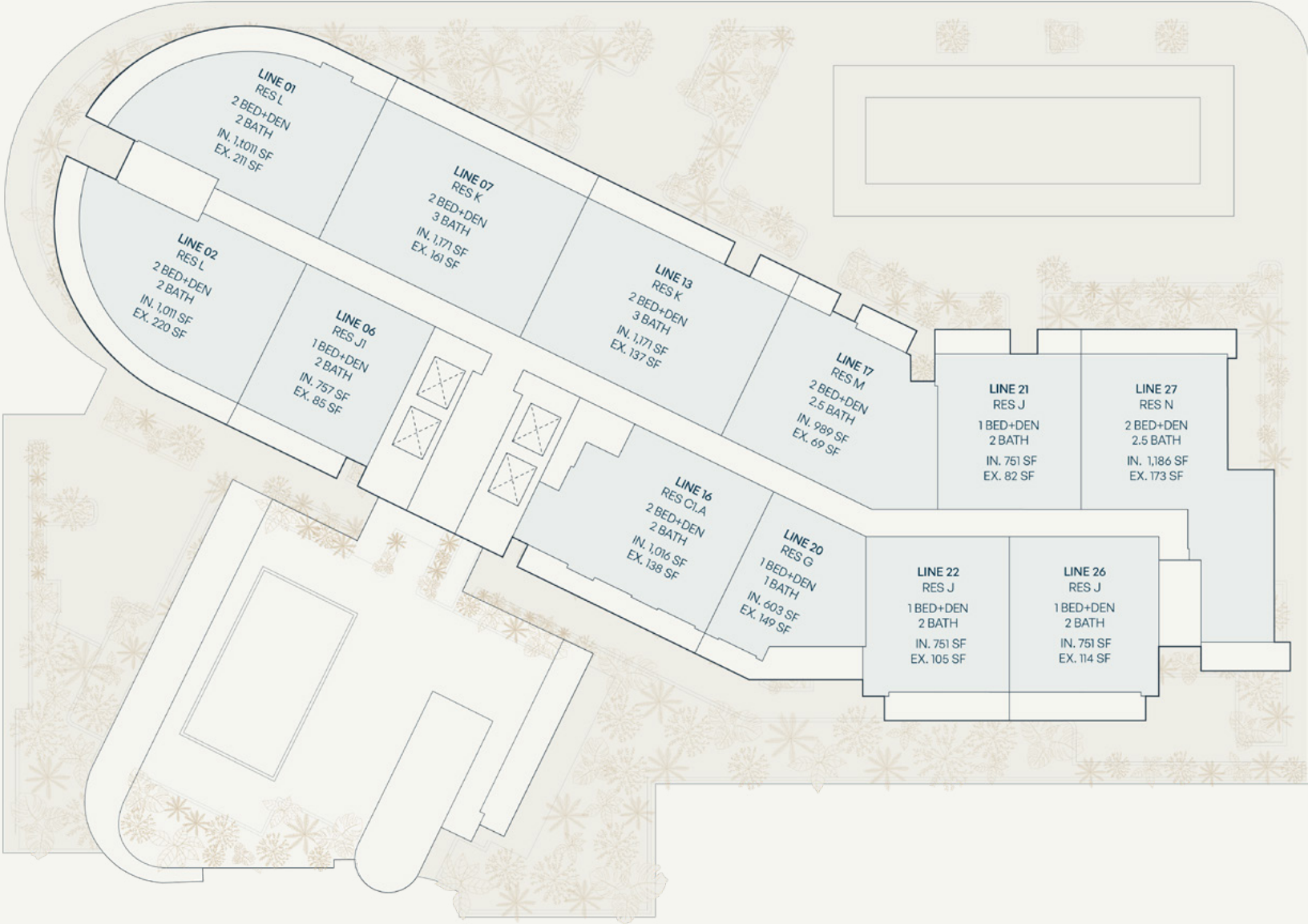

STATED DIMENSIONS ARE MEASURED TO THE EXTERIOR BOUNDARIES OF THE EXTERIOR WALLS AND THE CENTERLINE OF INTERIOR DEMISING WALLS AND IN FACT VARY FROM THE DIMENSIONS THAT WOULD BE DETERMINED BY USING THE DESCRIPTION AND DEFINITION OF THE "UNIT" SET FORTH IN THE DECLARATION (WHICH GENERALLY ONLY INCLUDES THE INTERIOR AIRSPACE BETWEEN THE PERIMETER WALLS AND EXCLUDES INTERIOR STRUCTURAL COMPONENTS). FOR YOUR REFERENCE, THE AREA OF THE UNIT, DETERMINED IN ACCORDANCE WITH THOSE DEFINED UNIT BOUNDARIES, NOTE THAT MEASUREMENTS OF ROOMS SET FORTH ON THIS FLOOR PLAN ARE GENERALLY TAKEN AT THE GREATEST POINTS OF EACH GIVEN ROOM (AS IF THE ROOM WERE A PERFECT RECTANGLE), WITHOUT REGARD FOR ANY CUTOUTS. ACCORDINGLY, THE AREA OF THE ACTUAL ROOM WILL TYPICALLY BE SMALLER THAN THE PRODUCT OBTAINED BY MULTIPLYING THE STATED LENGTH TIMES WIDTH. ALL DIMENSIONS ARE APPROXIMATE AND MAY VARY WITH ACTUAL CONSTRUCTION, AND ALL FLOOR PLANS AND DEVELOPMENT PLANS ARE SUBJECT TO CHANGE.